

# GunSafe

ORDER FORM

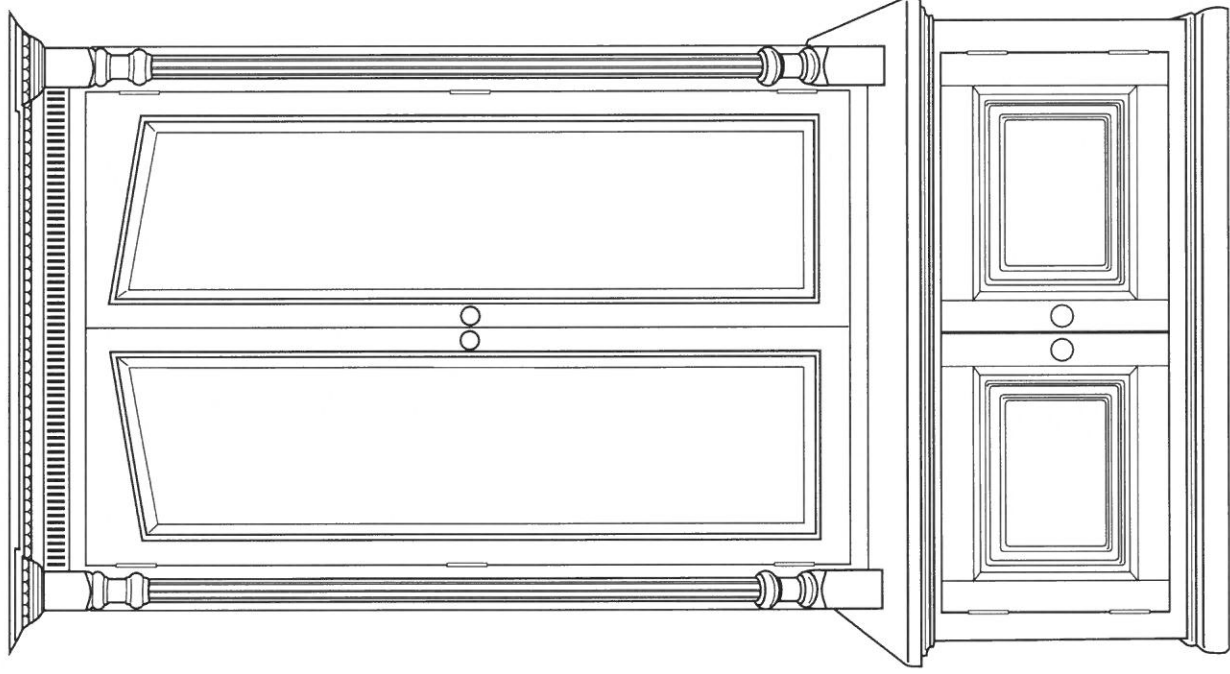

## WEDGE WOODWORKING

NELSON SCHLABACH

160 E CR 240 N ~ Arthur, IL 61911

Ph: 877-4-GunSafe (48-6723)

Fax: 217-451-0232

[safemvh@ibifax.com](mailto:safemvh@ibifax.com)

# GunSafe

## ORDER FORM GUIDE

Remove order form, fill it out and fax it to:  
217-451-0232 or mail to the address on form.

The new super efficient LED strip lights are  
now standard in all GunSafe Cabinets

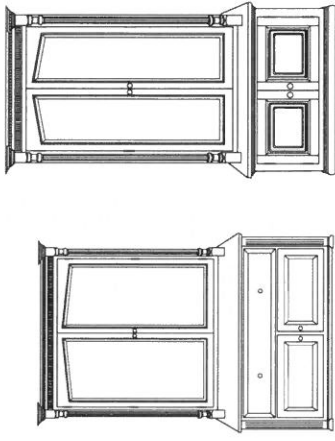

### ORDER FORM A

9, 12 & 18-GUN CABINETS  
6-GUN HORIZONTAL CABINET

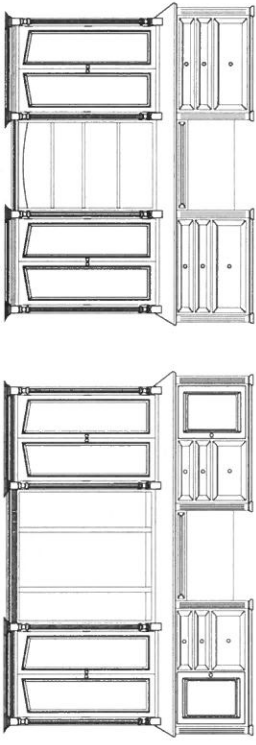

### ORDER FORM B

24 & 30-GUN DELUXE  
18 & 24-GUN DELUXE BOOKCASE

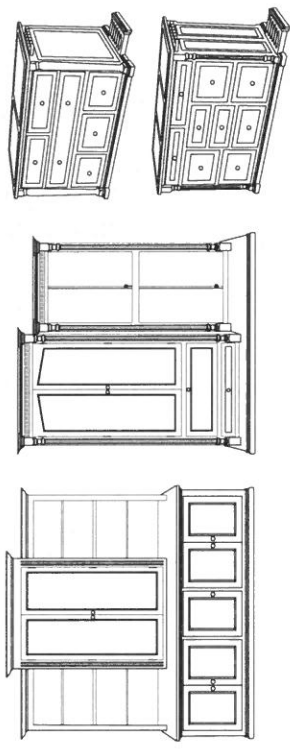

### ORDER FORM C

INGLE & CHARLES CLEANING ISLANDS  
12-GUN CABINET w/2 BOOKCASES  
12-GUN WITH PISTOL/KNIFE COMBO DISPLAY

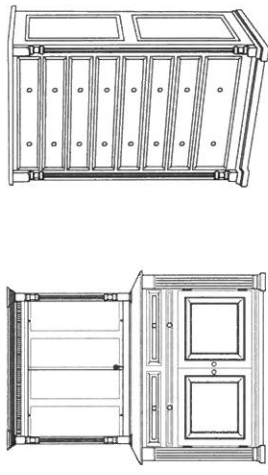

### ORDER FORM D

7, 14 & 21-GUN PISTOL DISPLAYS  
8-DRAWER PISTOL CABINET

### MISC. PRICE GUIDE

ADDITIONAL GUNSAFE OPTIONS

Although these gun cases are primarily designed to ensure maximum security for displaying fine firearms within a sophisticated gun case, they may not meet certain state's laws for storing guns and pistols. Please check your local laws for storage guidelines.

Quote Date \_\_\_\_\_ PO Date \_\_\_\_\_  
 Name \_\_\_\_\_ Exp. \_\_\_\_\_  
 Address \_\_\_\_\_ CC Billing Address \_\_\_\_\_  
 \_\_\_\_\_ Fax \_\_\_\_\_  
 \_\_\_\_\_ 3-Digit Code \_\_\_\_\_

### CUSTOMER INFORMATION

### PAYMENT TYPE

Check  
 Credit Card (3% fee - Am Exp 5% fee)

### STYLES

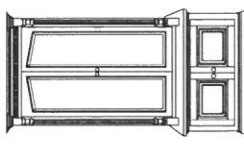

STANDARD

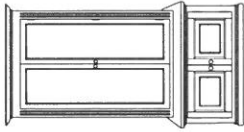

SHAKER

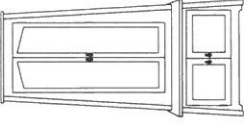

MIDWEST MISSION

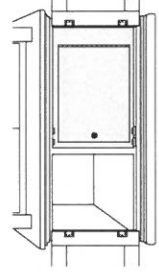

*Standard Base*

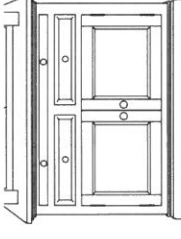

*Cleaning Shelf Base with Steel Safe Door*

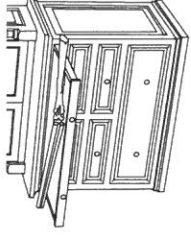

*5-Drawer Cleaning Shelf Base*

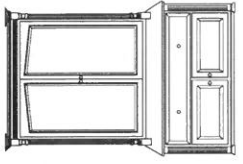

**6-GUN HORIZONTAL**

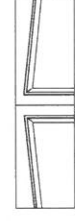
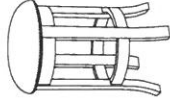

*Beveled Glass*

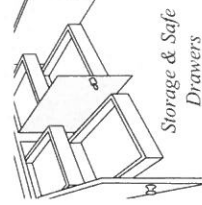

*Storage & Safe Drawers*

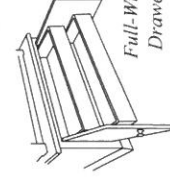

*Full-Width Drawers*



*Door Locks*



*Dehumidifier*

### BASE OPTIONS

Model	Oak & Knotty Alder	Cherry & 1/4 Sawn White Oak	Walnut & African Mahogany	Qty	Price	Amount
9-Gun	<input type="checkbox"/> GS10091 - \$5,554	<input type="checkbox"/> GS10092 - \$6,707	<input type="checkbox"/> GS10093 - \$7,631			
12-Gun	<input type="checkbox"/> GS10121 - \$6,234	<input type="checkbox"/> GS10122 - \$7,291	<input type="checkbox"/> GS10123 - \$8,294			
18-Gun	<input type="checkbox"/> GS10181 - \$7,849	<input type="checkbox"/> GS10182 - \$8,734	<input type="checkbox"/> GS10183 - \$9,658			
6-Gun (Hor)	<input type="checkbox"/> GSH61 - \$6,259	<input type="checkbox"/> GSH62 - \$7,315	<input type="checkbox"/> GSH63 - \$8,327			
<b>OPTIONS</b>						
<input type="checkbox"/> GS95	5-Drawer Cleaning Shelf Base				\$605	
<input type="checkbox"/> GS96	2-Drawer, 2-Door Leather Cleaning Shelf Base with Steel Safe Door				\$757	
<input type="checkbox"/> GS972	Houston Bar Stool (for cleaning shelf) 30" Desk ht. (Cherry)				\$958	
<b>Stain Color</b>						
	<input type="checkbox"/> Boston Cherry	<input type="checkbox"/> Autumn Haze				
<b>Glass Options</b>						
<input type="checkbox"/> GS9104	Clear Glass (standard)				\$341	
	<input type="checkbox"/> GS9105	Beveled Glass (most popular choice)				
	<input type="checkbox"/> GS9106	Antiqued Glass				
<b>Hardware Options</b>						
<input type="checkbox"/> Wood Knob	<input type="checkbox"/> Style A	<input type="checkbox"/> Style B	<input type="checkbox"/> Style C	<input type="checkbox"/> Style D	<input type="checkbox"/> Mission	
<b>Drawer Options (Optional)</b>						
	GS91021 Storage Compartment (circle one)			<input type="checkbox"/> 1-Drawer	<input type="checkbox"/> 2-Drawer	\$122 ea
	GS91022 Safe Compartment (circle one)			<input type="checkbox"/> 1-Drawer	<input type="checkbox"/> 2-Drawer	\$122 ea
	GS91023 2-Full Width Drawers (replaces storage and safe compartments)					\$153
<b>Line Drawer Bottoms (price each drawer)</b>						
	<input type="checkbox"/> GS65 Leather				\$101	
	<input type="checkbox"/> GS66 Felt				\$85	
<input type="checkbox"/> GS948	Add Child Locks (price each door or drawer)				\$58	
<input type="checkbox"/> GS934	Personalization (Plaque Engraved with your Name)			<input type="checkbox"/> <input type="checkbox"/>	\$122	
<input type="checkbox"/> GS966	18" Goldenrod Dehumidifier (installed)				\$102	
<b>SUBTOTAL</b>						
Illinois Residents include 7.25% Sales Tax						Tax
<input type="checkbox"/> GS81010 FREIGHT anywhere in Continental USA (to your curb)						\$950
<input type="checkbox"/> GS81020 FREIGHT AND SETUP (Unpackaged & carried in house)						\$1,250
<i>Prices Effective June 1, 2023</i>						<b>Total</b>

# GunSafe

## ORDER FORM B

**WEDGE WOODWORKING**  
 160 E CR 240 N ~ Arthur, IL 61911  
 Ph: 877-4-GunSafe (48-6723)  
 Fax: 217-451-0232  
 safemvh@ibyfax.com

Quote Date \_\_\_\_\_ PO Date \_\_\_\_\_  
**CUSTOMER INFORMATION**  
 Name \_\_\_\_\_  Check  Credit Card (3% fee - Am Exp 5% fee)  
 Address \_\_\_\_\_ Credit Card # \_\_\_\_\_  
 Phone(s) \_\_\_\_\_ Exp. \_\_\_\_\_ 3-Digit Code \_\_\_\_\_  
 Email \_\_\_\_\_ CC Billing Address \_\_\_\_\_  
 Fax \_\_\_\_\_

### PAYMENT TYPE

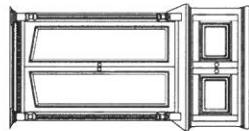

STANDARD

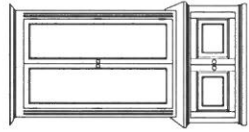

SHAKER

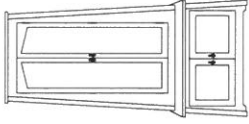

MIDWEST MISSION

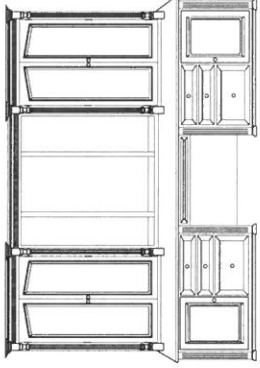

*GunSafe Deluxe*

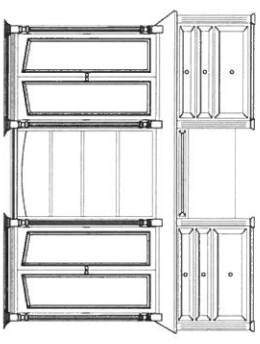

*GunSafe Deluxe Bookcase*

### STYLES

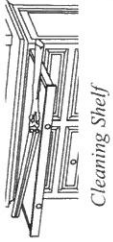

*Cleaning Shelf*

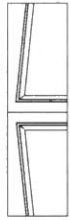
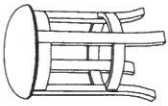

*Beveled Glass*

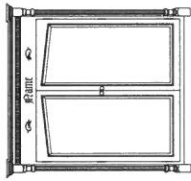

*Steel Safe Door*

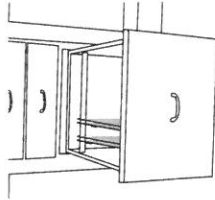

Model	Oak & Knotty Alder	Cherry & 1/4 Sawn White Oak	Walnut & African Mahogany	Qty	Price	Amount
<b>GUNSAFE DELUXE</b>						
24-Gun-116" w	<input type="checkbox"/> GSDX241 \$16,292	<input type="checkbox"/> GSDX242 \$18,579	<input type="checkbox"/> GSDX243 \$20,870			
30-Gun-132" w	<input type="checkbox"/> GSDX301 \$17,465	<input type="checkbox"/> GSDX302 \$19,842	<input type="checkbox"/> GSDX303 \$22,463			
<b>GUNSAFE DELUXE BOOKCASE</b>						
18-Gun-93-1/2" w	<input type="checkbox"/> GSDXB181 \$13,762	<input type="checkbox"/> GSDXB182 \$15,796	<input type="checkbox"/> GSDXB183 \$18,025			
24-Gun-109-1/2" w	<input type="checkbox"/> GSDXB241 \$14,996	<input type="checkbox"/> GSDXB242 \$17,116	<input type="checkbox"/> GSDXB243 \$19,515			
<b>OPTIONS</b>						
<input type="checkbox"/> GS955 Cleaning Shelf						\$605
<input type="checkbox"/> GS972 Houston Bar Stool (Cherry)						\$958
<input type="checkbox"/> GS947 Doors on Center Section						\$254
<input type="checkbox"/> GS91052 Beveled Glass on Center Section Doors						\$341
<b>Stain Color</b>	<input type="checkbox"/> Boston Cherry	<input type="checkbox"/> Autumn Haze				
<b>Glass Options</b>	<input type="checkbox"/> GS91054 Beveled Glass (most popular choice)					
	<input type="checkbox"/> GS91044 Clear Glass (standard)					
<b>Hardware Options (please circle one)</b>						
	<input type="checkbox"/> Wood Knob	<input type="checkbox"/> Style B	<input type="checkbox"/> Mission			
<input type="checkbox"/> GS934 Personalization (Plaque Engraved with your Name)	<input type="checkbox"/> Frame <input type="checkbox"/> Frame					
<input type="checkbox"/> GS935 Personalization (Name Engraved in Center of Cabinet)						
<input type="checkbox"/> GS966 18" Goldenrod Dehumidifier (installed)						
<input type="checkbox"/> GS976 Add Steel Safe Door in Base						
<input type="checkbox"/> GS945 Add Extra Drawers						
<input type="checkbox"/> GS946 Add File Drawers						
<input type="checkbox"/> GS947 Add Rollout Drawers Behind Doors						
				<b>SUBTOTAL</b>		
Illinois Residents include 7.25% Sales Tax						Tax
GS81012 <b>FREIGHT</b> anywhere in Continental USA (to your curb)						\$950
GS81020 <i>Freight and Setup (Unpackaged &amp; Carried in House)</i>						\$1,250
					<b>Total</b>	

**Prices Effective June 1, 2023**

50% Down Payment Amount

# GunSafe

## ORDER FORM C

**WEDGE WOODWORKING**  
 160 E CR 240 N ~ Arthur, IL 61911  
 Ph: 877-4-GunSafe (48-6723)  
 Fax: 217-451-0232  
 safemvh@ibyfax.com

Quote Date \_\_\_\_\_ PO Date \_\_\_\_\_  
 Check  
 Credit Card # \_\_\_\_\_  
 Exp. \_\_\_\_\_  
 CC Billing Address \_\_\_\_\_  
 Fax \_\_\_\_\_  
 3-Digit Code \_\_\_\_\_

### CUSTOMER INFORMATION

Name \_\_\_\_\_  
 Address \_\_\_\_\_  
 Phone(s) \_\_\_\_\_  
 Email \_\_\_\_\_

### PAYMENT TYPE

Credit Card (3% fee - Am Exp 5% fee)

### STYLES

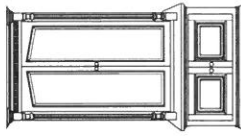

STANDARD

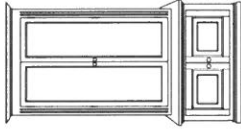

SHAKER

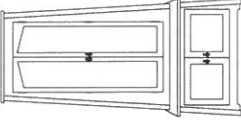

MIDWEST MISSION

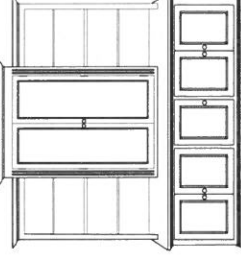

12-Gun with 2 Bookcases  
 12-Gun Knife/Pistol Combo Display

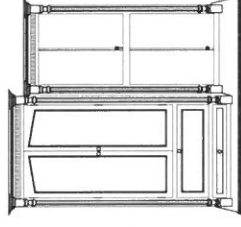

Ingie Island

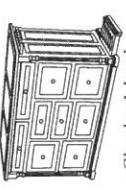

Charles Island

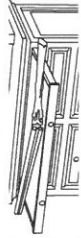

Cleaning Shelf

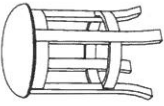

Beveled Glass

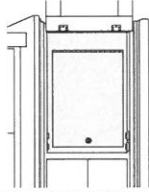
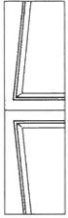

Steel Safe Door

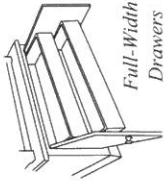

Full-Width Drawers

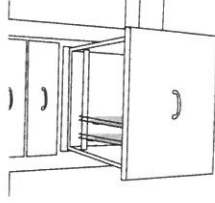

Model	Oak & Knotty Alder	Cherry & 1/4 Sawn White Oak	Walnut & African Mahogany	Qty	Price	Amount
<b>CHARLES GUN CLEANING ISLAND - 63-3/4" W - 36" D - 42" H</b>						
	<input type="checkbox"/> GS7601 - \$6,246	<input type="checkbox"/> GS7602 - \$7,090	<input type="checkbox"/> GS7603 - \$8,030			
<b>INGLE GUN CLEANING ISLAND 55-1/2" W - 36" D - 36" H</b>						
	<input type="checkbox"/> GS7501 - \$5,463	<input type="checkbox"/> GS7502 - \$6,215	<input type="checkbox"/> GS7503 - \$7,129			
<b>12-GUN WITH 2 BOOKCASES - 90" W - 22" D - 87" H</b>						
	<input type="checkbox"/> GS1221 - \$9,750	<input type="checkbox"/> GS1222 - \$11,070	<input type="checkbox"/> GS1223 - \$12,436			
<b>12-GUN, 14-PISTOL/KNIFE COMBO DISPLAY - 68" W - 19" D - 88" H</b>						
	<input type="checkbox"/> GS12141 - \$11,046	<input type="checkbox"/> GS12142 - \$12,235	<input type="checkbox"/> GS12143 - \$13,485			
<b>OPTIONS</b>						
	<input type="checkbox"/> GS955 Cleaning Shelf				\$605	
	<input type="checkbox"/> GS972 Houston Bar Stool (Cherry)				\$958	
<b>Stain Color</b>	<input type="checkbox"/> Boston Cherry	<input type="checkbox"/> Autumn Haze				
<b>Glass Options</b>	<input type="checkbox"/> GS9105 Beveled Glass (most popular choice)				\$341	
	<input type="checkbox"/> GS9104 Clear Glass (standard)					
<b>Hardware Options (please circle one)</b>						
	<input type="checkbox"/> Wood Knob	<input type="checkbox"/> Style B	<input type="checkbox"/> Mission			
	<input type="checkbox"/> GS934 Personalization (Plaque Engraved with your Name)				\$122	
	<input type="checkbox"/> GS935 Personalization (Name Engraved in Center of Cabinet)	<input type="checkbox"/> Name			\$191	
	<input type="checkbox"/> GS966 18" Goldenrod Dehumidifier (installed)				\$102	
	<input type="checkbox"/> GS976 Add Steel Safe Door in Base				\$430	
	<input type="checkbox"/> GS945 Add Extra Drawers				\$160	
	<input type="checkbox"/> GS946 Add File Drawers				\$191	
	<input type="checkbox"/> GS947 Add Rollout Drawers Behind Doors				\$122	
<b>SUBTOTAL</b>						
Illinois Residents include 7.25% Sales Tax					Tax	
GS81011 <b>FREIGHT</b> anywhere in Continental USA (to your curb)						\$950
GS81020 <i>Freight and Setup (Unpackaged &amp; Carried in House)</i>						\$1,250
<b>Prices Effective June 1, 2023</b>						
50% Down Payment Amount						
<b>Total</b>						

Complete Order Form and fax to: 877-5-GunSafe (48-6723) or mail to address above

# GunSafe

## ORDER FORM D

**WEDGE WOODWORKING**  
 160 E CR 240 N ~ Arthur, IL 61911  
 Ph: 877-4-GunSafe (48-6723)  
 Fax: 217-451-0232  
 safemvh@ibyfax.com

Quote Date \_\_\_\_\_ PO Date \_\_\_\_\_

### CUSTOMER INFORMATION

Name \_\_\_\_\_ **PAYMENT TYPE**  
 Address \_\_\_\_\_  Check  Credit Card (3% fee - Am Exp 5% fee)  
 Phone(s) \_\_\_\_\_ Exp. \_\_\_\_\_ 3-Digit Code \_\_\_\_\_  
 Email \_\_\_\_\_ CC Billing Address \_\_\_\_\_  
 Fax \_\_\_\_\_

**STYLES**

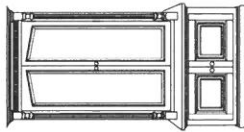
STANDARD  

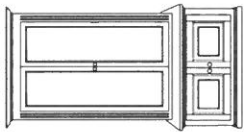
SHAKER  

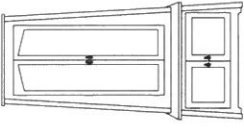
MIDWEST MISSION  

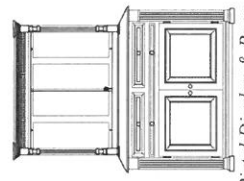

*Pistol Display & Base*

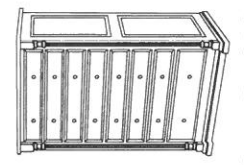

*8-Drawer Pistol Cabinet*

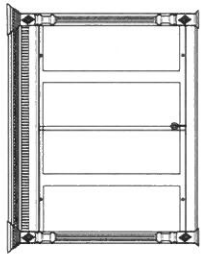

*Diamonds on 4 Corners*

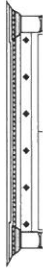

*Ebony Inlays Between 2 Lines*

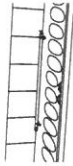

*Dehumidifier*

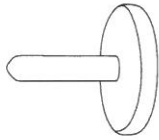

*Magnetic Base w/  
Standoff*

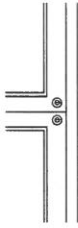

*Child Locks*

Model	Oak & Knotty Alder	Cherry & 1/4 Sawn White Oak	Walnut & African Mahogany	Qty	Price	Amount
<b>7-GUN PISTOL DISPLAY - 30-3/4" w - 10" d - 37-1/2 H</b>						
	<input type="checkbox"/> GS40071 - \$3,080	<input type="checkbox"/> GS40072 - \$3,322	<input type="checkbox"/> GS40073 - \$3,842			
<b>7-GUN PISTOL DISPLAY BASE - 30" w - 20-1/2" d - 39" H</b>						
	<input type="checkbox"/> GS41071 - \$2,131	<input type="checkbox"/> GS41072 - \$2,448	<input type="checkbox"/> GS41073 - \$2,855			
<b>14-GUN PISTOL DISPLAY - 52-3/4" w - 10" d - 37-1/2 H</b>						
	<input type="checkbox"/> GS40141 - \$3,641	<input type="checkbox"/> GS40142 - \$3,982	<input type="checkbox"/> GS40143 - \$4,391			
<b>14-GUN PISTOL DISPLAY BASE - 52" w - 20-1/2" d - 39" H</b>						
	<input type="checkbox"/> GS41141 - \$2,790	<input type="checkbox"/> GS41142 - \$3,202	<input type="checkbox"/> GS41143 - \$3,708			
<b>21-GUN PISTOL DISPLAY - 77-1/2" w - 10" d - 37-1/2 H</b>						
	<input type="checkbox"/> GS40211 - \$4,333	<input type="checkbox"/> GS40212 - \$4,720	<input type="checkbox"/> GS40213 - \$5,397			
<b>21-GUN PISTOL DISPLAY BASE - 76-3/4" w - 20-1/2" d - 39" H</b>						
	<input type="checkbox"/> GS41211 - \$3,365	<input type="checkbox"/> GS41212 - \$3,801	<input type="checkbox"/> GS41213 - \$4,344			
<b>8-DRAWER PISTOL CABINET (Drop pull hardware &amp; felt-lined drawers standard) - 41" w - 22" d - 53" H</b>						
	<input type="checkbox"/> GS4811 - \$3,610	<input type="checkbox"/> GS4812 - \$4,047	<input type="checkbox"/> GS4813 - \$4,501			
<i>Leather Cleaning Shelf is standard on all Pistol Display Bases</i>						
<b>PISTOL DISPLAY OPTIONS</b>						
<input type="checkbox"/> GS9575	Black Ebony Diamond Inlays on 4 Corners				\$146	
<input type="checkbox"/> GS9576	Black Ebony Diamond Inlays in Center of Top (between 2 lines of black ebony)				\$239	
<input type="checkbox"/> GS988	Magnetic Base with Standoff for Additional Support for Larger Pistols				\$20	
<input type="checkbox"/> GS934	Personalization (Plaque Engraved with your Name)		<input type="checkbox"/> FRAME		\$122	
<input type="checkbox"/> GS935	Personalization (Name Engraved on Front of Cabinet Frame)				\$191	
<input type="checkbox"/> GS966	18" Goldenrod Dehumidifier (installed)				\$102 ea	
<b>Stain Color</b>						
	<input type="checkbox"/> Boston Cherry	<input type="checkbox"/> Autumn Haze				
<b>BASE OPTIONS</b>						
<input type="checkbox"/> GS65	Leather Lined Drawer Bottoms				\$101	
<input type="checkbox"/> GS66	Felt Lined Drawer Bottom (includes 1/4" foam cushion)				\$85	
<input type="checkbox"/> GS948	Add Child Locks to Doors and/or Drawers (price each door or drawer)				\$58	
<b>Hardware Options (please circle one)</b>						
<input type="checkbox"/> Wood Knob	<input type="checkbox"/> Style B	<input type="checkbox"/> Mission				
<input type="checkbox"/> GS986	Leather Inlaid on Top of Base Cabinet				\$350	
Illinois Residents include 7.25% Sales Tax						
GS81010 <b>FREIGHT</b> anywhere in Continental USA						
GS81020 Freight and Setup (Unpackaged & Carried in House)						
<b>Prices Effective June 1, 2023</b>					50% Down Payment Amount	
					Tax	\$950
					Total	\$1,250

Complete Order Form and fax to: 877-5-GunSafe (48-6723) or mail to address above

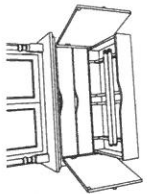

3-Drawer Base w/  
Fly Rod Holders

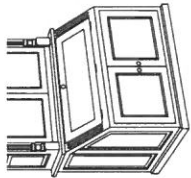

Angled Pistol Display

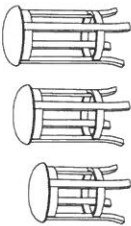

20" - 26" - 32"  
Houston Bar Stools

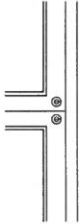

Child Locks

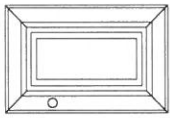

Miter Corner Door

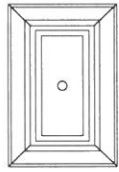

Miter Corner Drawer

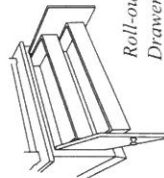

Roll-out  
Drawers

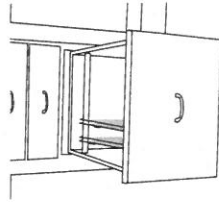

ADDITIONAL BASE OPTIONS	Price
GS956 3-Drawer Base with Fly Rod Holders	\$503
GS957 Angled Pistol Display in Base	\$1,265
GS955 Cleaning Shelf	\$605
<b>CUSTOM FINISHES</b>	
GS9614 Stain Color Match	\$176
GS9624 Distressing <i>(add to Cabinet Price)</i>	10%
GS9634 Glazing <i>(add to Cabinet Price)</i>	10%
<b>INLAYS &amp; CARVINGS</b>	
<b>HOUSTON BAR STOOLS (Cherry)</b>	
GS972 - 20" Tall Stool for 30" Desk Height	\$958
GS982 - 26" Tall Stool for 36" Counter Height	\$1,041
GS992 - 32" Tall Stool for 42" Bar Height	\$1,123
GS934 Personalization <i>(Plaque Engraved with your Name)</i>	\$122
GS935 Personalization <i>(Name Engraved in Center of Cabinet)</i>	\$191
GS966 18" Goldenrod Dehumidifier <i>(installed)</i>	\$102
GS989 Trigger Locks with Base <i>(to Display Pistols)</i>	\$18.50 ea.
GS988 Magnetic Base Pistol Support	\$20
GS948 Add Child Locks on Doors or Drawers <i>(price each)</i>	\$58
GS976 Add Steel Safe Door in Base	\$430
GS977 Magnetic Knife Display 20"	\$557
<b>ADDITIONAL DRAWER OPTIONS</b>	
GS945 Add Extra Drawers	\$160
GS946 Add File Drawers	\$191
GS947 Add Rollout Drawers Behind Doors	\$122
GS65 Line Drawer Bottom with Leather	\$101
GS66 Line Drawer Bottom with Felt	\$85
GS50 Miter Corner Doors or Drawers	\$40

**Prices Effective June 1, 2023**

### STYLE B KNOB



### MISSION HANDLE



### MISSION HANDLE



### WOOD KNOB

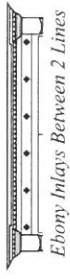

Ebony Inlays Between 2 Lines

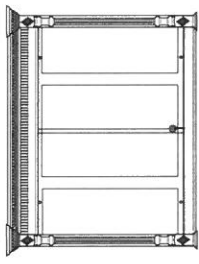

Diamonds on 4 Corners



Name

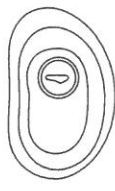

Trigger Lock for Pistol  
Display

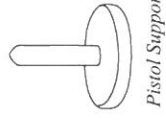

Pistol Support

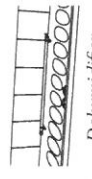

Dehumidifier

# GunSafe™

For the esteemed collector  
of fine guns, GunSafe is  
the perfect display case  
for your investment.

GunSafe Cabinets  
are manufactured  
in Arthur, IL

*We welcome you to  
stop by our facility*

**1-877-4-GunSafe**  
[www.customgunsafe.com](http://www.customgunsafe.com)

**GunSafe**  
160 E. CR 240 N. / Arthur, IL 61911  
Ph. 877-4-GunSafe (48-6723)  
Fx. 877-5-GunSafe (48-6723)  
[safemvh@ibyfax.com](mailto:safemvh@ibyfax.com)

We're located 1½ miles South  
and 1¼ miles East of Arthur, IL  
Latitude = 39.687253  
Longitude = 88.438492

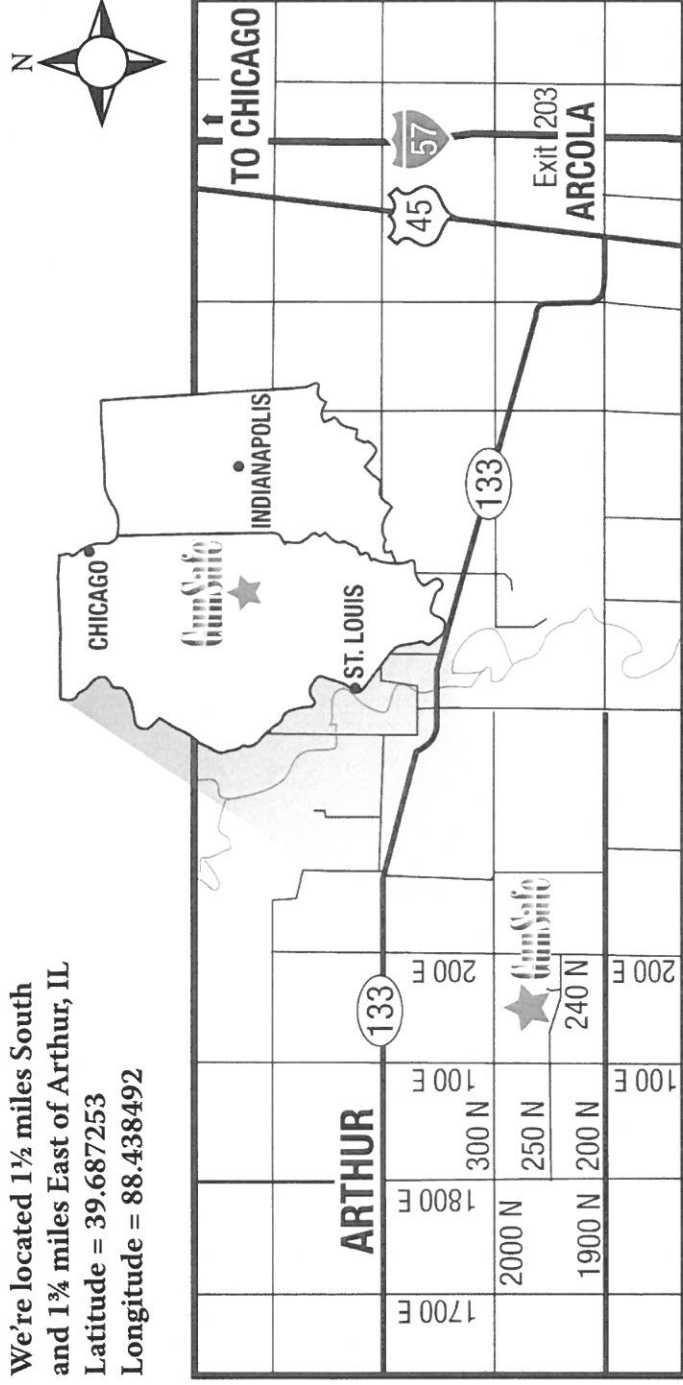

Protect your investment. Showcase your collection.